

GENERAL NOTE:
 ALL DIMENSIONS ARE GIVEN WITHOUT DEDUCTIONS FOR BEVELING WELD GAP OR ALLOWANCE FOR MACHINING UNLESS NOTED OTHERWISE (U.N.O).
 ALL SHARP EDGES SHALL BE ROUNDED TO A RADIUS OF MIN. 2 MM.
 REMOVE ALL BURRS, WELDSLAG AND SPATTERS.

SURFACE TREATMENT:
 SURFACE PRE AND POST TREATMENT ACCORDING TO FINISHING METHOD.
 SURFACE FINISHING : GALVANIZED AFTER WELDING

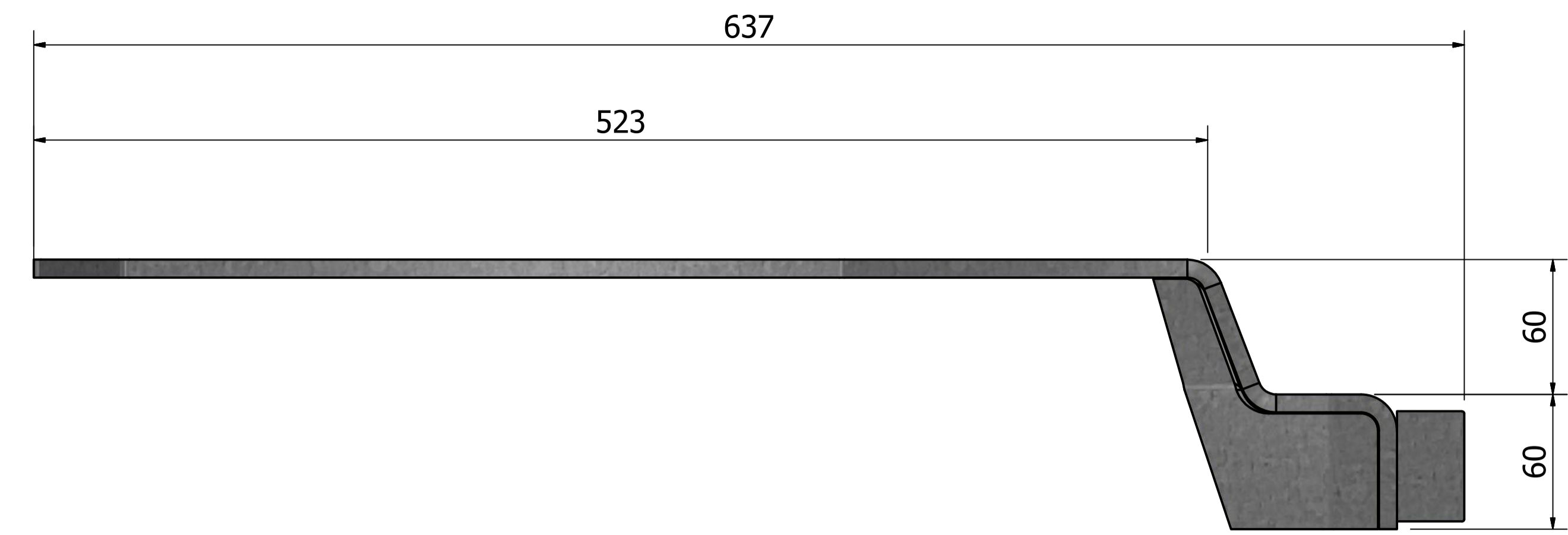

SCANIA RIGHT BRACKET (1 : 2)

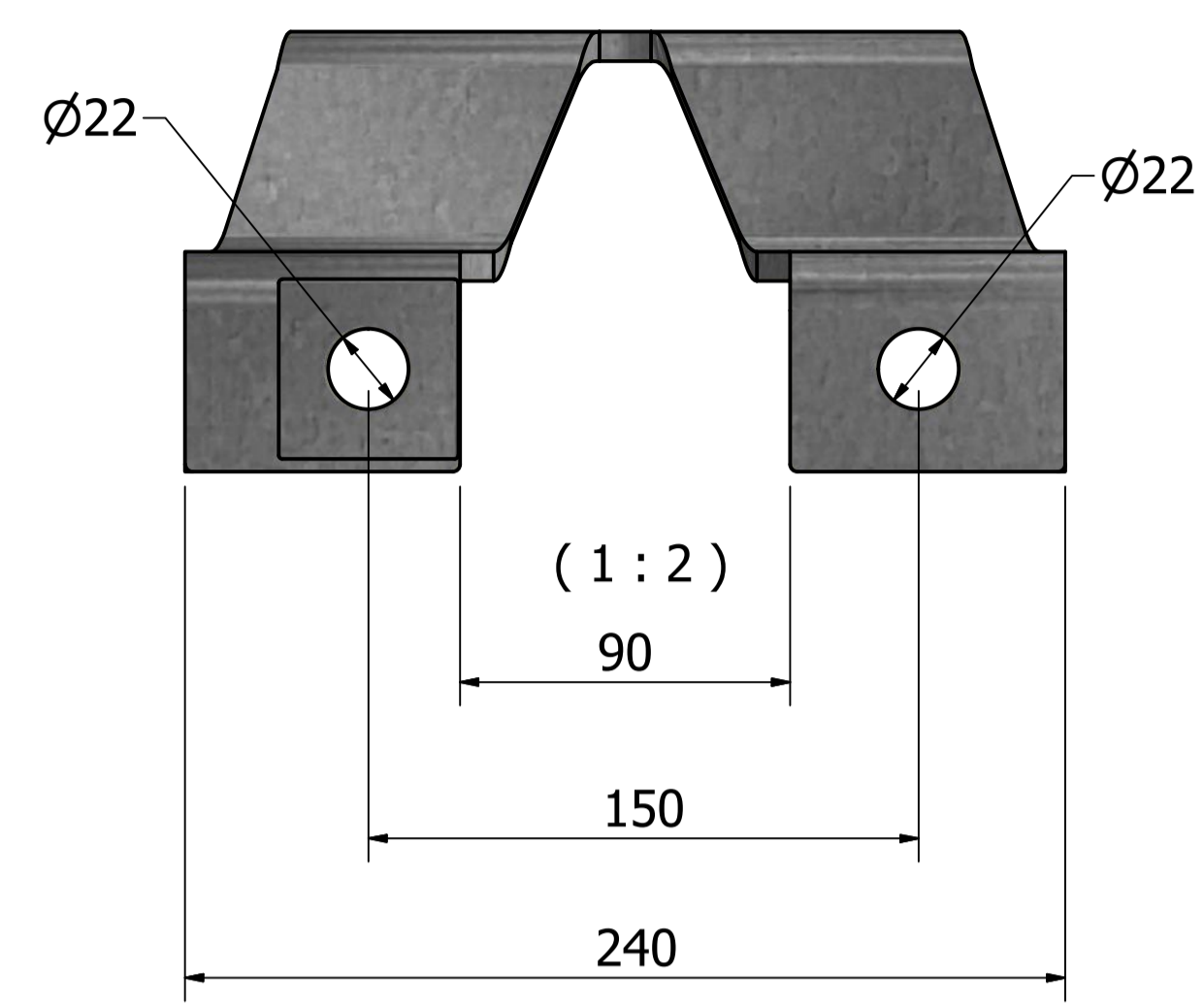
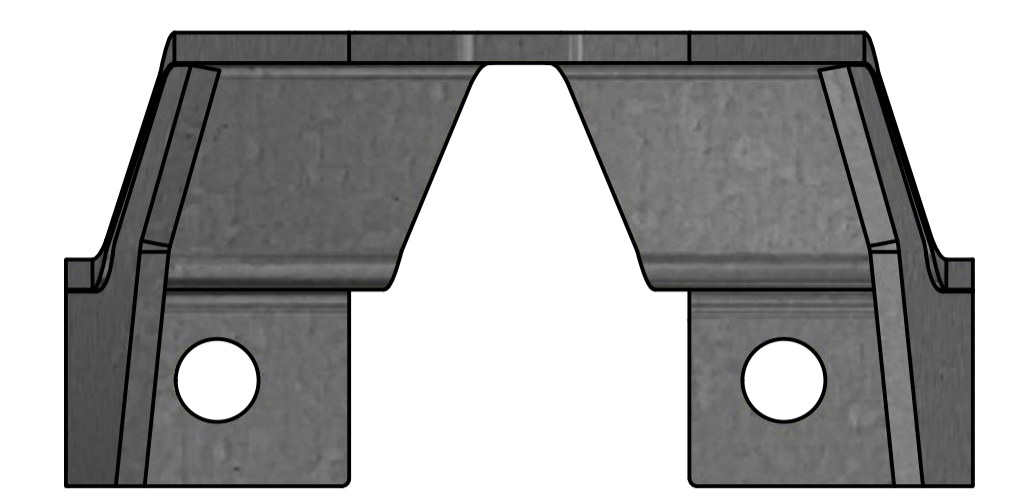

(1 : 2)

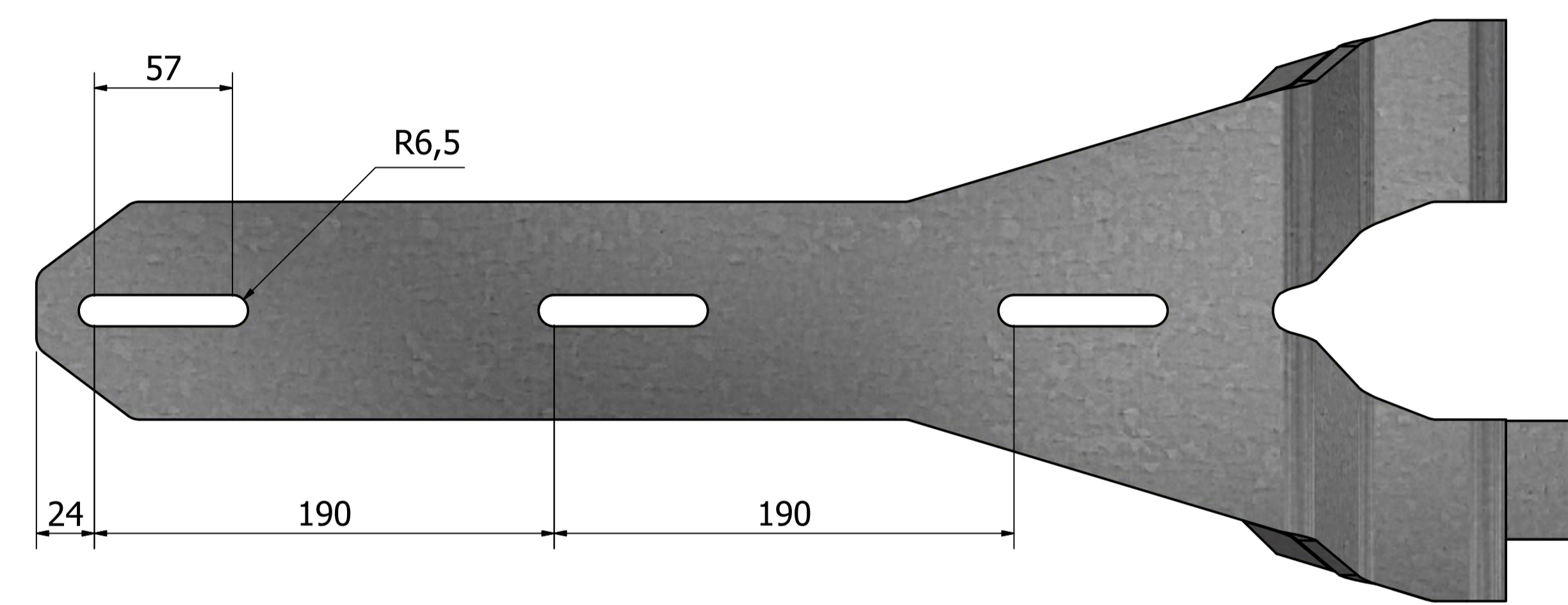

(1 : 2)

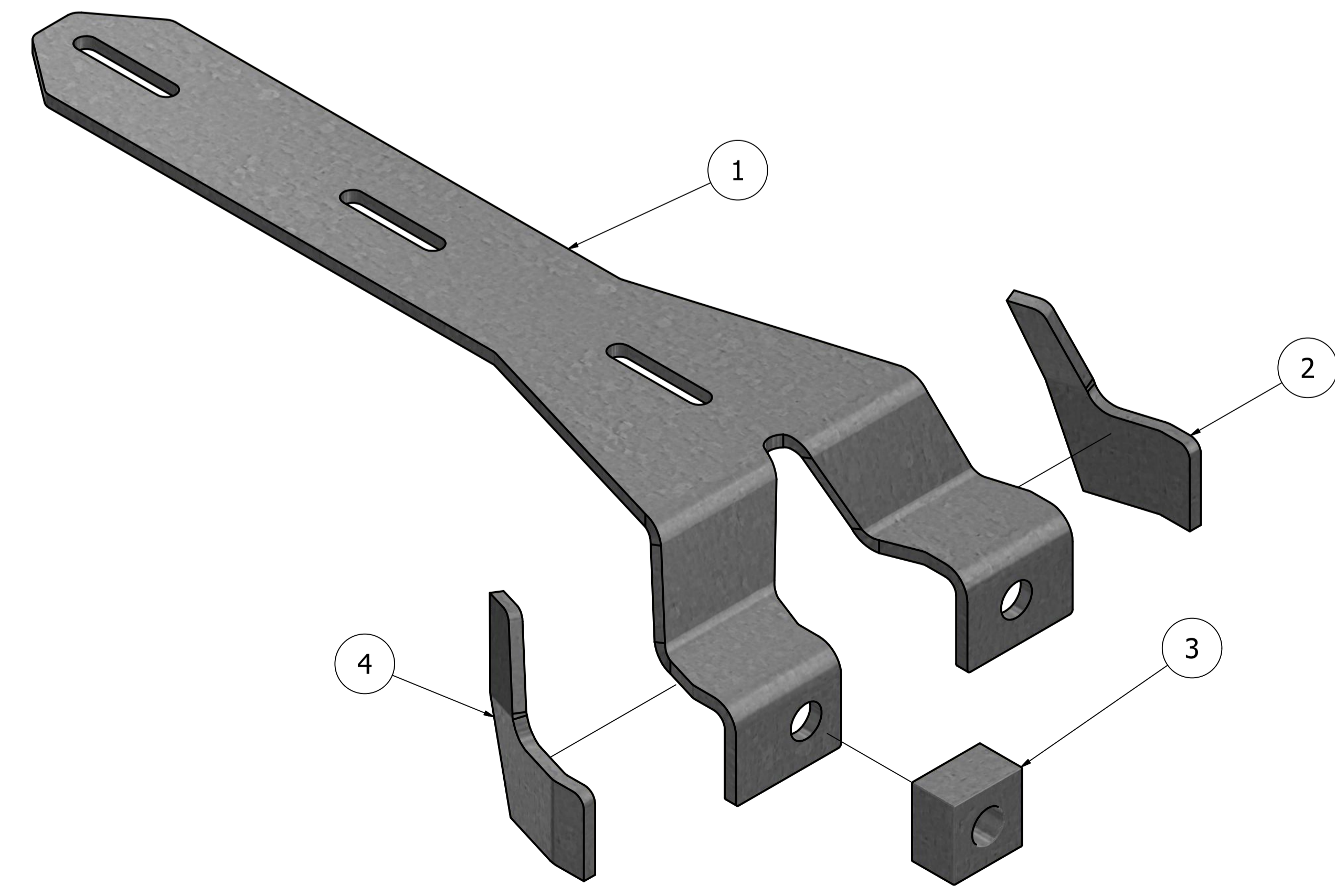

SCANIA RIGHT BRACKET (1 : 2)

ITM	QTY	TITLE	DESCRIPTION	MATERIAL	MASS	REV	ITEM NO
4	1	SUPPORT SCANIA BRCK01	FLATP. 8 x 105 x 112	Steel, Mild	0,3 kg	A	8000185
3	1	BOOT	BAR. 30 x 49 x 49	Steel, Mild	0,5 kg	A	8000183
2	1	SUPPORT SCANIA BRCK02	FLATP. 8 x 105 x 112	Steel, Mild	0,3 kg	A	8000184
1	1	RIGHT SIDE BRACKET	FLATP. 8 x 240 x 684	Steel, Mild	4,8 kg	A	8000186
DETAIL / MATERIAL LIST							
C		ISSUED FOR MANUFACTURING	03.10.2014	BAR	SAS	BAR	
B		ISSUED FOR REVIEW	28.12.2013	BAR	SAS	BAR	
A		REISSUED FROM WS DRAWINGS	16.12.2013	BAR	SAS	JEB	
REV	DESCRIPTION	DATE	DES	CHK	APPR		
REVISION HISTORY							
Designed by	Projection	Sheet size	Total Weight	Date			
BAR		A1	6 kg	16.12.2013			
				MAIN ASSEMBLY AUTOLINE SCANIA RIGHT BRACKET		Drawing Number 8000182 Revision : Sheet B 1 / 3	
<small>Box 56-9476 Borkenes - Norway Mail : safesand@online.no www.autoline.no TEL : +47-77 09 23 00 Fax : +47-77 09 24 77</small>							